

GN 135.1 | Two-way connecting clamps

for linear actuators, aluminium



- 1
- 2
- 3
- 4
- 5
- 6
- 7
- 8
- 9
- 10
- 11
- 12
- 13
- 14
- 15
- 16
- 17
- 18

MATERIAL

Aluminium, epoxy resin coating, RAL 9005 black colour, matte finish.
AISI 304 stainless steel screws and nuts.
Connector nut in natural steel.

STANDARD EXECUTIONS

- **GN 135.1-B-B**: two round holes.
- **GN 135.1-B-V**: round hole and square hole.
- **GN 135.1-V-V**: two square holes and one connector nut.
- **GN 135.1-V-B**: square hole complete with connector nut and round hole.

FEATURES AND APPLICATIONS

The connecting clamps GN 135.1 can normally be matched with square linear actuators GN 291.1 (see page 1376) or round GN 291 (see page 1374).

They can be assembled with tubes of diameters d_1/s_1 and d_2/s_2 of different dimensions.

By clamping the guide hole d_1 / s_1 it is possible to adjust the actuator positioning and to lock the slider after having set up the final position.
The clamping screws d_4 and d_5 can be replaced respectively with clamping kits type GN 911-M8-55 and GN 911-M10-55 (see page 1372).

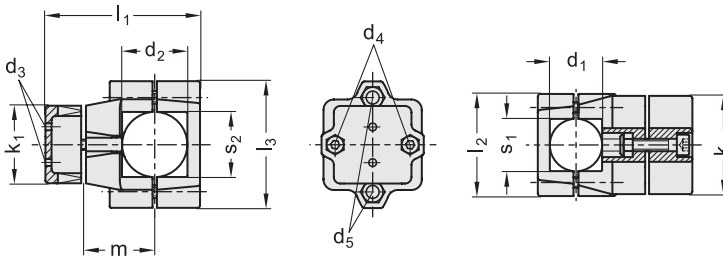
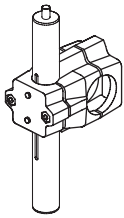

Conversion Table	
1 mm = 0.039 inch	
d1	
mm	inch
30	1.18
40	1.57
50	1.97

METRIC

GN 135.1-B-B

Code	Description	d1 Round hole	d2 Round hole	d3	d4	d5	k1	k2	l1	l2	l3	m	⚖
GN.44401	GN 135.1-B30-B40-2-SW	30	40	M4	M8	M10	60	76	120	79	98	55	869
GN.44403	GN 135.1-B30-B50-2-SW	30	50	M5	M8	M10	60	76	120	79	98	55	834
GN.44411	GN 135.1-B40-B50-2-SW	40	50	M6	M8	M10	60	76	120	79	98	55	813

GN 135.1-B-V

Code	Description	d1 Round hole	s2 Square hole	d3	d4	d5	k1	k2	l1	l2	l3	m	⚖
GN.44405	GN 135.1-B30-V40-2-SW	40	30	M4	M8	M10	60	76	120	79	98	55	869
GN.44407	GN 135.1-B30-V50-2-SW	50	30	M5	M8	M10	60	76	120	79	98	55	834
GN.44413	GN 135.1-B40-V50-2-SW	50	40	M6	M8	M10	60	76	120	79	98	55	813

GN 135.1-V-V

Code	Description	s1 Square hole	s2 Square hole	d3	d4	d5	k1	k2	l1	l2	l3	m	⚖
GN.44425	GN 135.1-V30-V40-2-SW	30	40	M4	M8	M10	60	76	120	79	98	55	869
GN.44427	GN 135.1-V30-V50-2-SW	30	50	M5	M8	M10	60	76	120	79	98	55	834
GN.44433	GN 135.1-V40-V50-2-SW	40	50	M6	M8	M10	60	76	120	79	98	55	813

GN 135.1-V-B

Code	Description	s1 Square hole	d2 Round hole	d3	d4	d5	k1	k2	l1	l2	l3	m	⚖
GN.44421	GN 135.1-V30-B40-2-SW	30	40	M4	M8	M10	60	76	120	79	98	55	869
GN.44423	GN 135.1-V30-B50-2-SW	30	50	M5	M8	M10	60	76	120	79	98	55	834
GN.44431	GN 135.1-V40-B50-2-SW	40	50	M6	M8	M10	60	76	120	79	98	55	813

Connecting clamps